

THE GREAT BOOKMARKS CHALLENGE

A LITERARY-THEMED, COMMUNITY-WIDE

SCAVENGER HUNT

IN THE CITY OF LITERATURE!



April 8th-May 18th

Locations throughout the Iowa City area
Visit iywp.org for more info

IOWA

Magid Center for
Undergraduate Writing

THE GREAT BOOKMARKS CHALLENGE

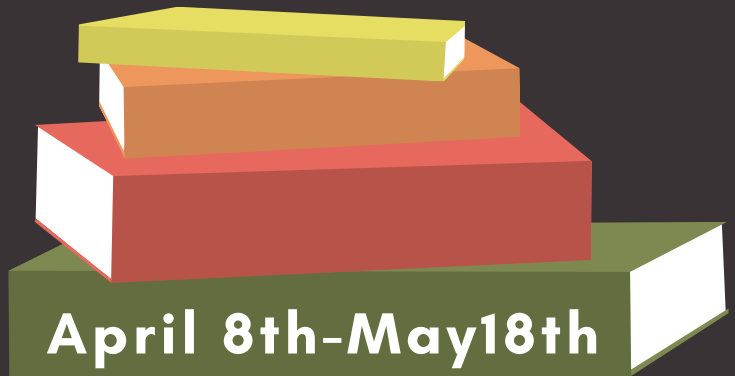

A LITERARY THEMED COMMUNITY-WIDE SCAVENGER HUNT

HOW IT WORKS:

- 1) Visit all 14 Bookmarks Challenge locations and find the hidden Bookmarks station at each location.
- 2) At each location, once you have found the Bookmarks station, open the hidden wooden book and follow the directions. Each station has a unique literary challenge to complete.
- 3) Take a selfie at each hidden station and share your response to the literary challenge on social media, by **tagging IYWP** and using the hashtag **#greatbookmarkschallenge2022**. Or, email **IYWP-GreatBookmarks@uiowa.edu**. Your profile must be set to public in order to participate.
- 4) For each station completed, you will be entered into a raffle drawing for an assortment of fun prizes. Earn a bonus raffle entry by visiting at least seven stations!

Locations throughout Iowa City and surrounding area
Visit iywp.org for more information



IOWA

Magid Center for
Undergraduate Writing



IOWA

Magid Center for
Undergraduate Writing

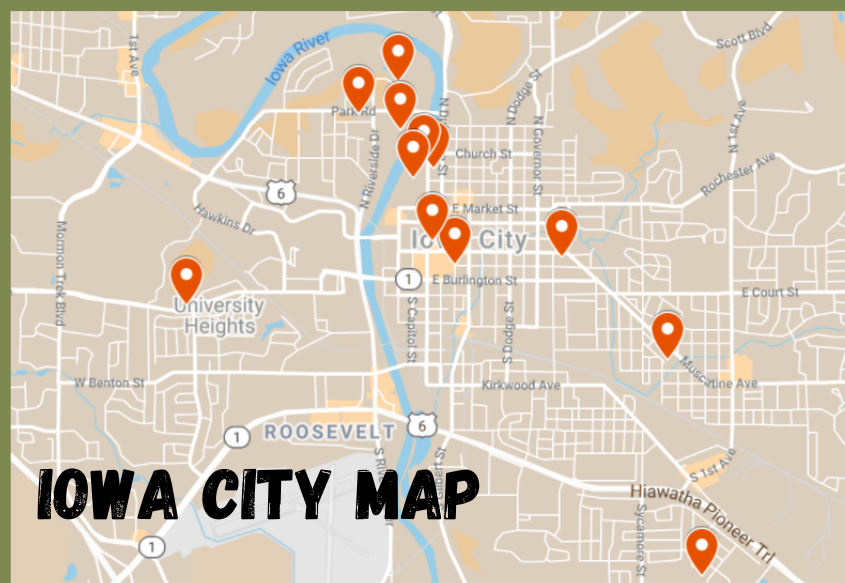
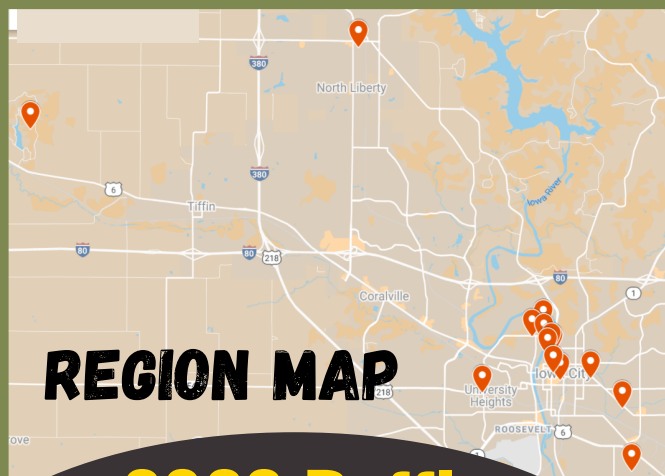

2022 Raffle

Prizes include:

Grand Prize Winner:

An overnight stay at the historic Highlander Hotel, two mainstage tickets at Riverside Theater's new ped mall location, and a \$100 gift certificate to Basta.

Additional Prizes:

New Pioneer Coop Gift Basket & Certificate (\$100), Various items from Sidekick Coffee & Books (\$50 gift certificate, Sidekick t-shirt, Coffee Flight for Two) Raygun t-shirts, Raygun gift certificate (\$30), FilmScene Date Night Package, Englert gift certificate (\$50), Daydreams Comics Custom Book Selection, Iowa Children's Museum day passes, handmade beaded bookmark from Beadology, Hawkeye swag from Iowa Book, and more!

Visit iywp.org for more information



IOWA

Magid Center for
Undergraduate Writing

What to bring:

We recommend you bring your favorite writing utensil and paper to each station. Alternatively, be prepared to take notes and do some writing on your mobile device. Each station requires you to complete a writing challenge which you need to submit (by social media or email) in order to be eligible for the raffle.



Check the hours:

Most station activities are found outdoors. However, a few locations are found indoors. Check the maps below before you go and then go online to check the hours of that business or location.

Reading the Maps

We've done our best to provide additional information about each station location on the maps below. Whether the station is located inside, outside, and details about accessibility are outlined below. While some of the stations are located indoors, most are located outdoors. None of the locations require an entry fee.

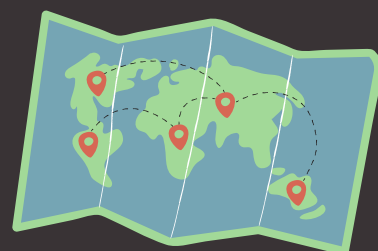

Visit iywp.org for more information

CENTER FOR THE BOOK

20 W. DAVENPORT ST. IOWA CITY, 52242
(NORTH HALL)

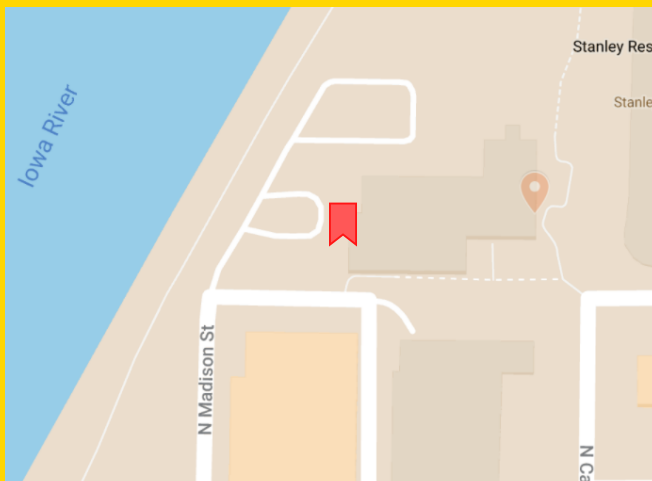

THIS
STATION IS:



OUTSIDE

REQUIRES:



CLIMBING STAIRS

FAIRMEADOWS PARK

2451 MIAMI DR, IOWA CITY, 52240

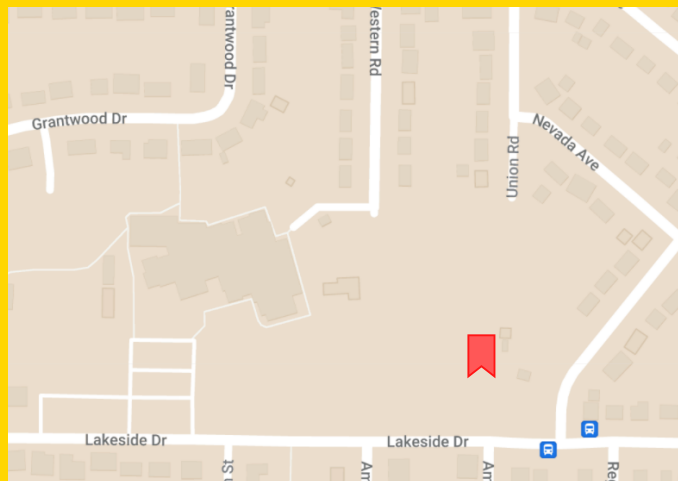

THIS
STATION IS:



OUTSIDE



ACCESSIBLE

HANCHER AUDITORIUM

141 PARK RD, IOWA CITY, 52242

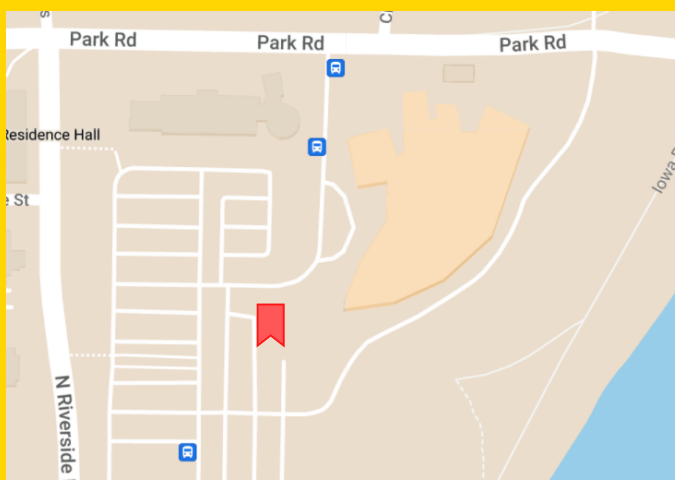

THIS
STATION IS:



OUTSIDE



ACCESSIBLE

INTERNATIONAL WRITING PROGRAM

430 N. CLINTON ST. IOWA CITY, 52245

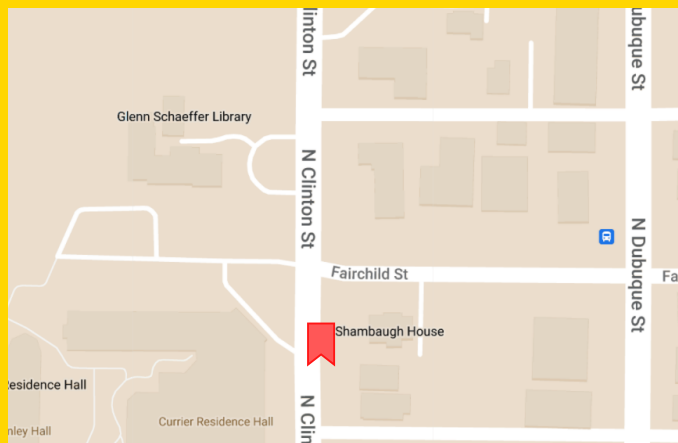

THIS
STATION IS:



OUTSIDE



ACCESSIBLE

IOWA BOOK

8 S CLINTON ST, IOWA CITY, 52240



THIS STATION IS:



INSIDE



ACCESSIBLE

REQUIRES:

CHECK BUSINESS HOURS



IOWA CITY PUBLIC LIBRARY

123 S LINN ST, IOWA CITY, 52240

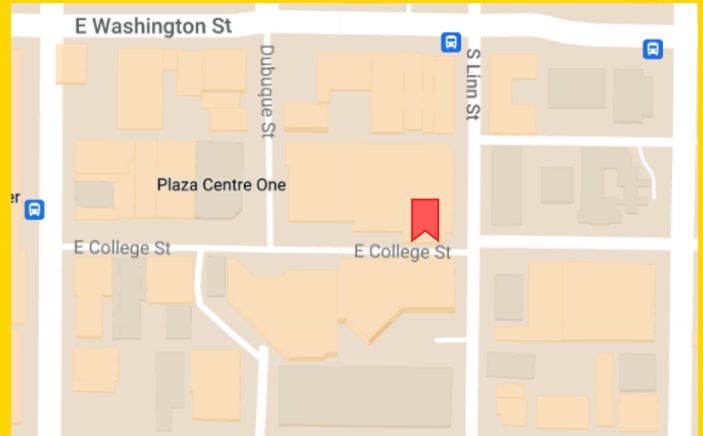

THIS STATION IS:



INSIDE



ACCESSIBLE

REQUIRES:

CHECK BUSINESS HOURS



JAMES ALAN MCPHERSON PARK

1858 7TH AVE CT, IOWA CITY, 52240

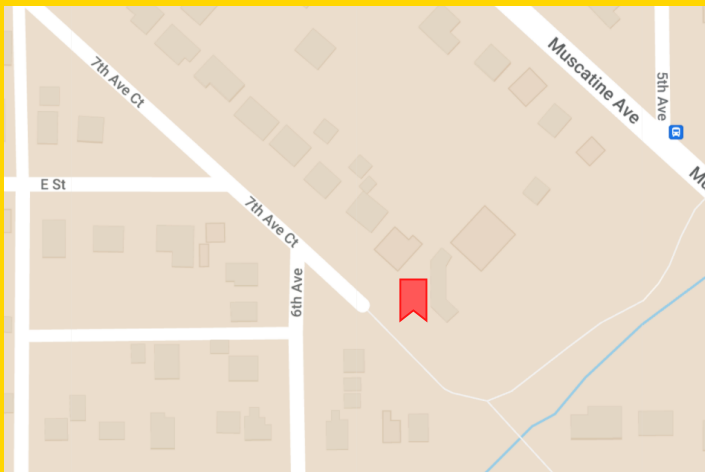

THIS STATION IS:



OUTSIDE



ACCESSIBLE

KENT PARK

2048 US-6 NW, OXFORD, IA 52322

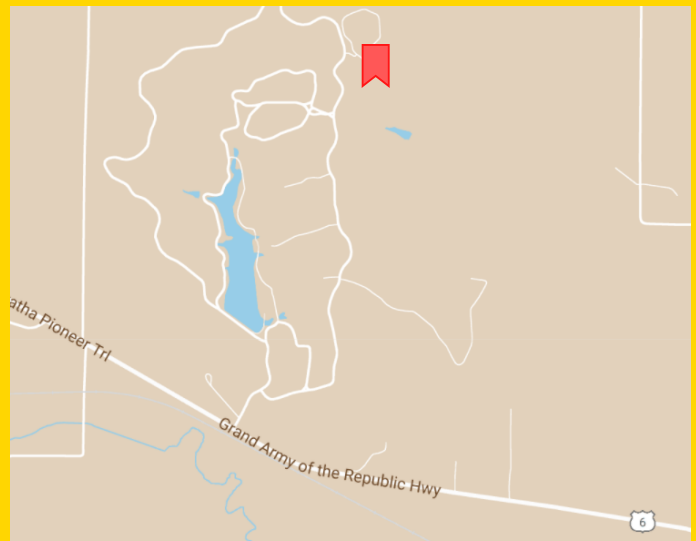

THIS STATION IS:



OUTSIDE



ACCESSIBLE

LITERARY GROVE

507 NORTH CLINTON ST. IOWA CITY, 52245

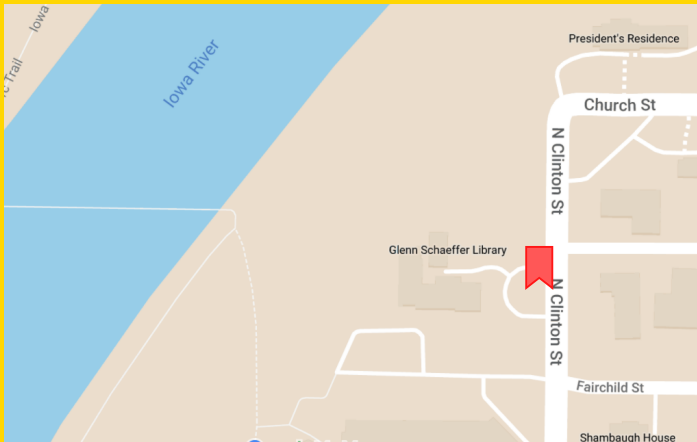

**THIS
STATION IS:**



OUTSIDE

REQUIRES:

**NAVIGATING
SLIGHTLY HILLY
TERRAIN**



NORTH LIBERTY LIBRARY

520 W. CHERRY ST. NORTH LIBERTY, IA 52317

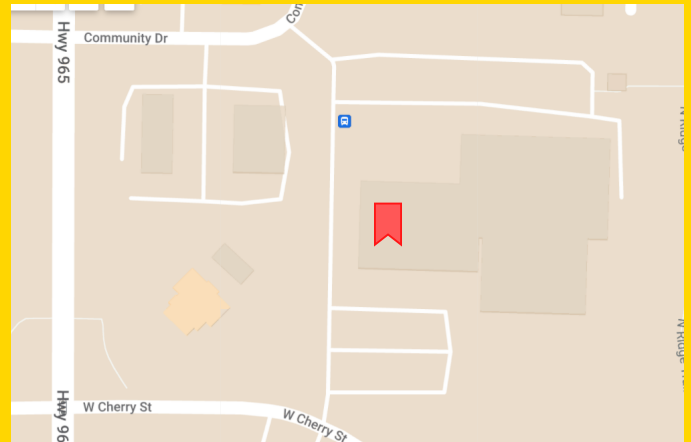

THIS STATION IS:



INSIDE



ACCESSIBLE

REQUIRES:

CHECK BUSINESS HOURS



PORCH LIGHT LITERARY CENTER

1019 E WASHINGTON ST, IOWA CITY, 52240

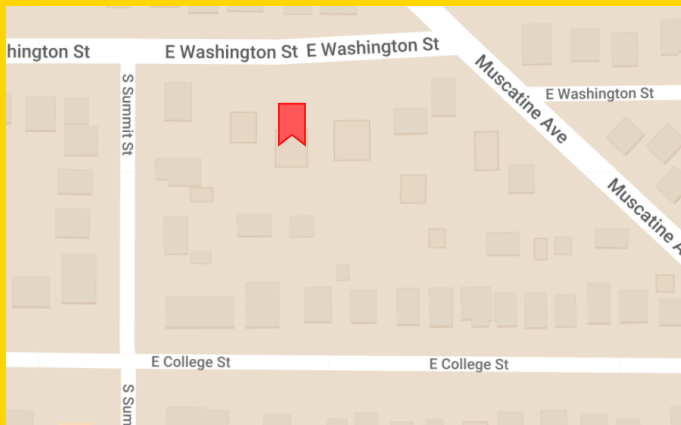

**THIS
STATION IS:**



OUTSIDE

REQUIRES:

CLIMBING STAIRS



SHAKESPEARE STAGE

200 PARK RD, IOWA CITY, 52246

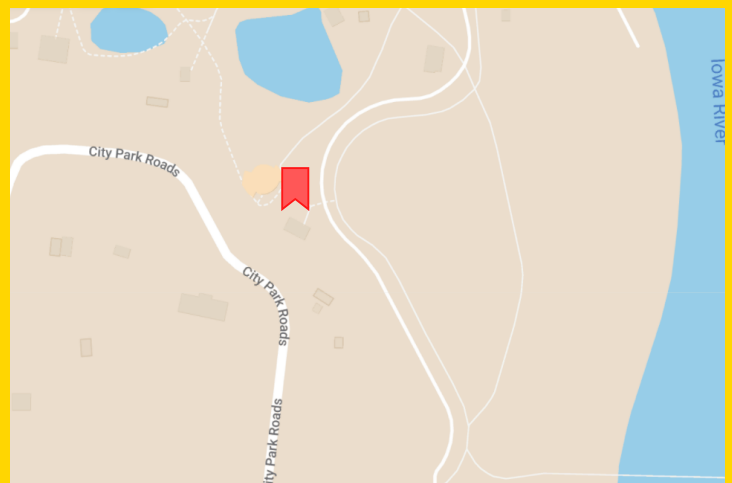

**THIS
STATION IS:**



OUTSIDE

REQUIRES:

CLIMBING STAIRS



SIDEKICK COFFEE & BOOKS

1310 1/2 MELROSE AVE, IOWA CITY, 52246

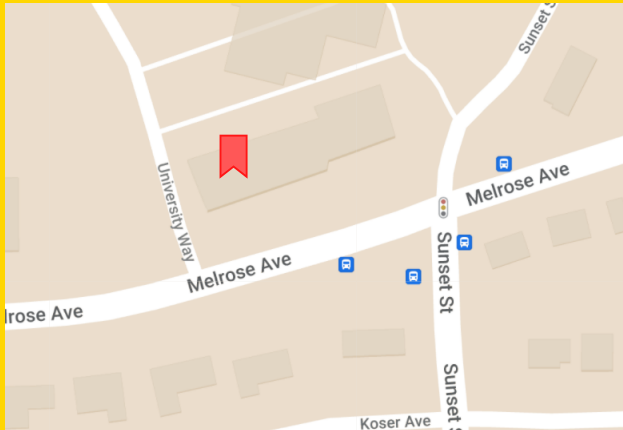

THIS STATION IS:



INSIDE



ACCESSIBLE

REQUIRES:

CHECK BUSINESS HOURS



UNIVERSITY OF IOWA PRESS

119 W. PARK RD, IOWA CITY, 52242

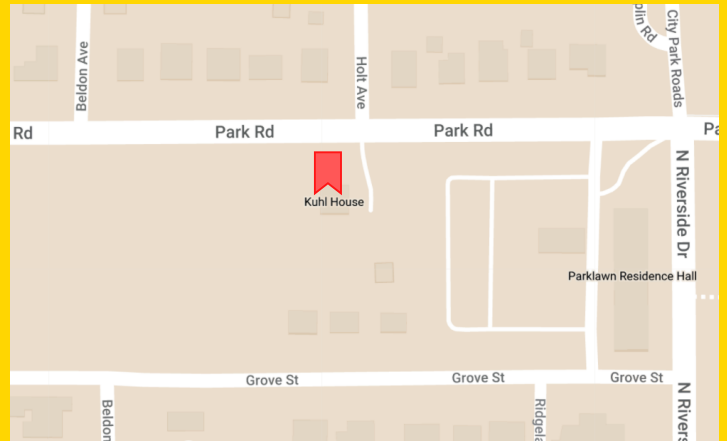

THIS STATION IS:



OUTSIDE

REQUIRES:

**NAVIGATING
SLIGHTLY HILLY
TERRAIN**



THANK YOU!

Thank you for participating in the Great Bookmarks Challenge! We hope you enjoyed the program and have been inspired to write more, and to learn more about our community's rich literary culture.

Thank you also to each of the partner sites who collaborated with us to make this event possible. Special thanks to Iowa City UNESCO City of Literature, for advising and promotions.

Finally, we want to offer a **huge thanks** to our donors. Each of the raffle prizes were generously donated by local businesses and community organizations. If you had fun with this event, please support these local groups by shopping at their stores, eating at their restaurants, or attending their events. Be sure to thank them for their support of this program!

Thanks! -from the IYWP Team